



Close Couple Kit Installation Instructions

Parts Supplied

(one of each of the following)

- A. Plate
- B. Bolts x 2
- C. Foam Washer
- D. Rubber Washer x 2
- E. Metal Washer x 2
- F. Wing Nuts x 2

No Tools Required

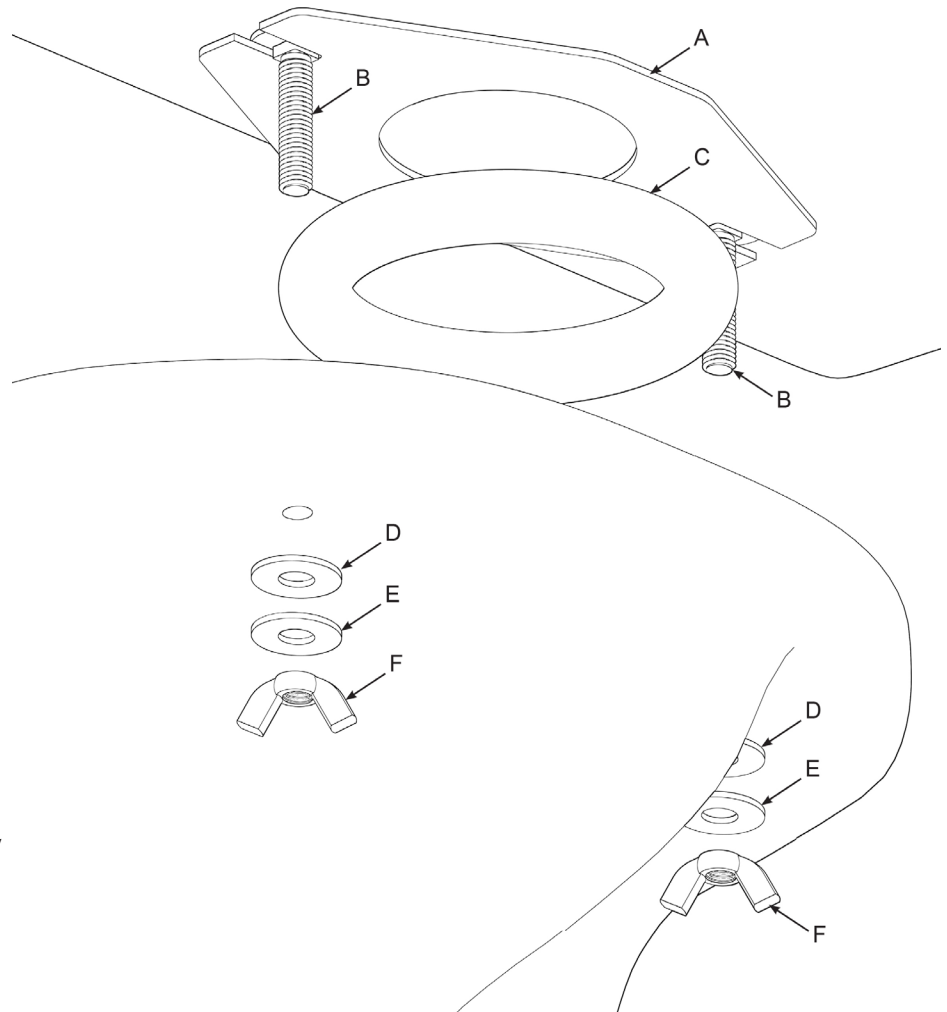

Assembly

1. Check and familiarise yourself with all the components.
2. Take plate (A) and place it over the cistern's outlet thread. Once this is in position, use the locking nut for the outlet (not supplied in this kit), to tighten the plate into position, ensuring you do not over tighten and the plate cut outs remains horizontal to the cistern front throughout.
3. Take bolts (B) and insert them into plate (A) cut outs.
4. Take doughnut washer (C) and place it over the outlet thread, tight up against plate (A).
5. The cistern can now be positioned over the W.C. pan, take care lowering the cistern ensuring bolts (B) fit through their designated holes.
6. Take Washers (D+E) and place them over the bolts, using wing nut (F) to hold them onto the bolt. It is advised to do one at a time just at this stage.
7. Now the washers and wing nuts are in place, tighten them up. This will pull the cistern into place and compress the doughnut washer creating the seal between the cistern and the W.C. pan. Take care not to over tighten.
8. Once all other connections have been made, check the operation and ensure there are no leaks.

IMPORTANT INFORMATION



We accept no liability for products fitted incorrectly, and where the correct testing procedures have not been used, resulting in the escape of water. The finished surfaces on the product are hard and durable and we recommend regular cleaning to maintain their appearance. They should only be cleaned with warm soapy water, under no circumstances should any aggressive or abrasive cleaning agent be used as it can lead to deterioration of the high quality finish.

FOR MORE INFORMATION ABOUT ANY OF OUR PRODUCTS VISIT

www.vivasanitary.co.uk

Units 1-2, Capitol Trading Park
Kirkby Bank Road, Knowsley Industrial Park
Liverpool, Merseyside, L33 7SY

Tel: +44 (0)151 546 0531 Fax: +44 (0)151 549 4187