

Code:

T12D

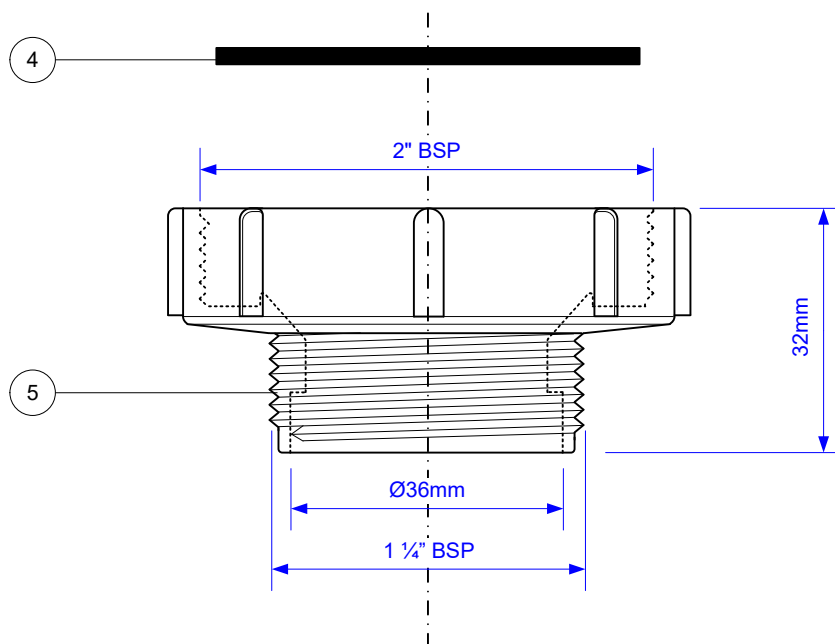

Part No.	Code
1	P-B-260X350-MCA (Plastic Bag)
2	P-B-S150X200-MCA (Plastic Bag)
3	P-C-S1Q (Carton)
4	RW3-ISO
5	T12DBODY

**Note:** 1 1/4" BSP spigot should fit into bottom socket.

© McALPINE  
15/03/2007

Drawing verified  
correct as of:

30/03/2023  
RM

DRAWN BY

RM

SCALE

1: 1

REVISED

15/03/2007, 19/01/2016  
28/02/2020, 30/03/2023

FILENAME

T12D.VSD

DATE

30/03/2023